

**PR**  
PROPERTY

**4 Twigden Court Mount Pleasant Road, Luton, Bedfordshire, LU3 2RL  
£1,050 PCM**

- EXCLUSIVE TO PR PROPERTY LETTINGS
- CLOSE TO LEAGRAVE STATION
- AVAILABLE JULY 2026

- ONE BEDROOM HOUSE
- CLOSE TO M1 AND HOSPITAL
- MUST BE VIEWED

- ALLOCATED PARKING
- GAS CENTRAL HEATING

Exclusive to P&R Property — Tucked away in the popular Leagrave area of Luton, this well-presented one bedroom home is ideal for those seeking comfort, convenience and great connectivity. Offered in great condition throughout, the property is ready to move straight into with no hassle. With Leagrave train station, the Luton & Dunstable Hospital and the M1 motorway all within easy reach, the location really does tick every box. Early viewing is strongly advised — a home like this won't hang around for long. Available from July 2026.

### ENTRANCE HALL

**LIVING ROOM 11'9" X 10'9" (3.57M X 3.28M)**

**KITCHEN 8'2" X 6'5" (2.50M X 1.95M)**

### LANDING

**BEDROOM 1 11'8" X 10'8" (3.56M X 3.25M)**

### BATHROOM

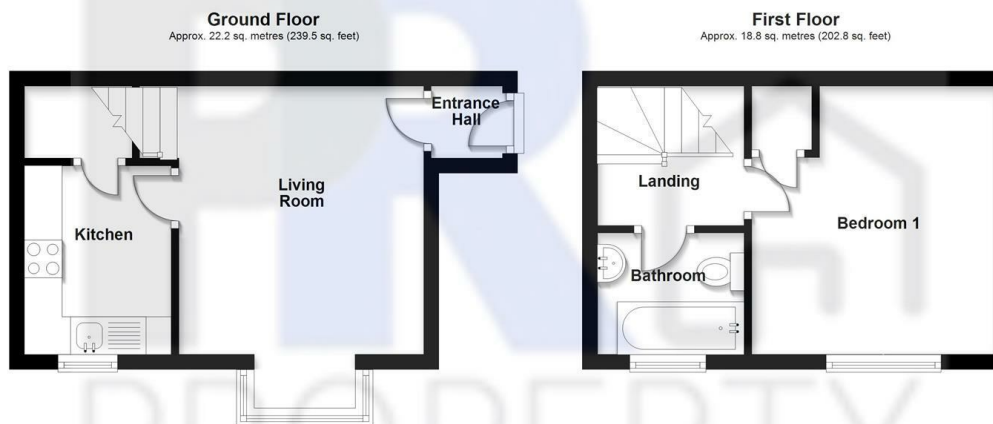

Total area: approx. 41.1 sq. metres (442.3 sq. feet)  
4 twigdon court

Energy Efficiency Rating		Current	Potential
Very energy efficient - lower running costs			
(92 plus)	A		
(81-91)	B		
(69-80)	C		
(55-68)	D		
(39-54)	E		
(21-38)	F		
(1-20)	G		
Not energy efficient - higher running costs			
England & Wales		71	80
		EU Directive 2002/91/EC	